

Parent and Pupil Guide to connecting an ipad to WiFi

You can access Microsoft Teams either using the Microsoft Teams App, or via any web browser. The instructions here, explain how to access Microsoft Teams through a web browser.

1. Turn your ipad on. The first screen will look like this. Find the folder **Apple Apps**

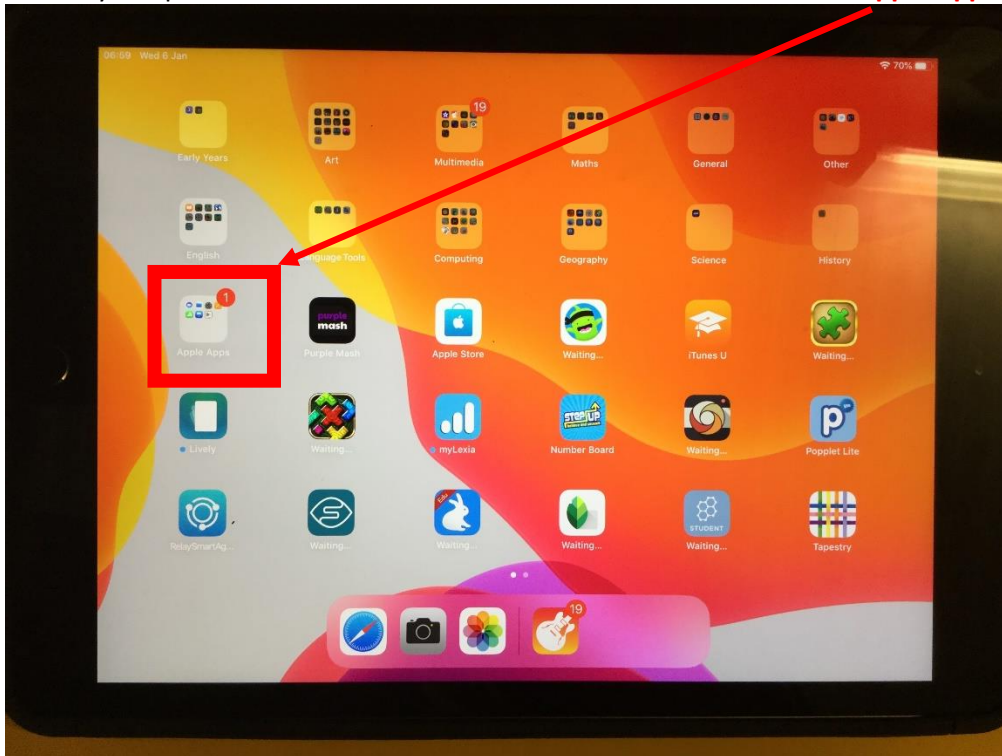

2. Next, tap on **settings**

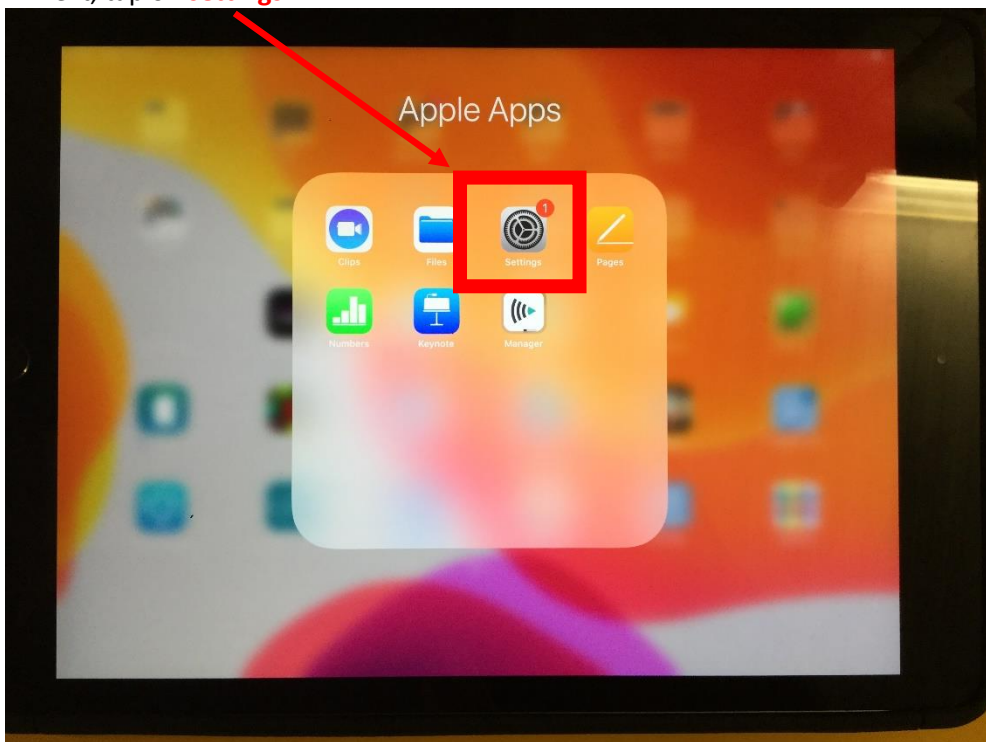

3. Scroll with your finger on the left hand side to find **WiFi**. You will then need to know your own WiFi ID and passcode from your home router.

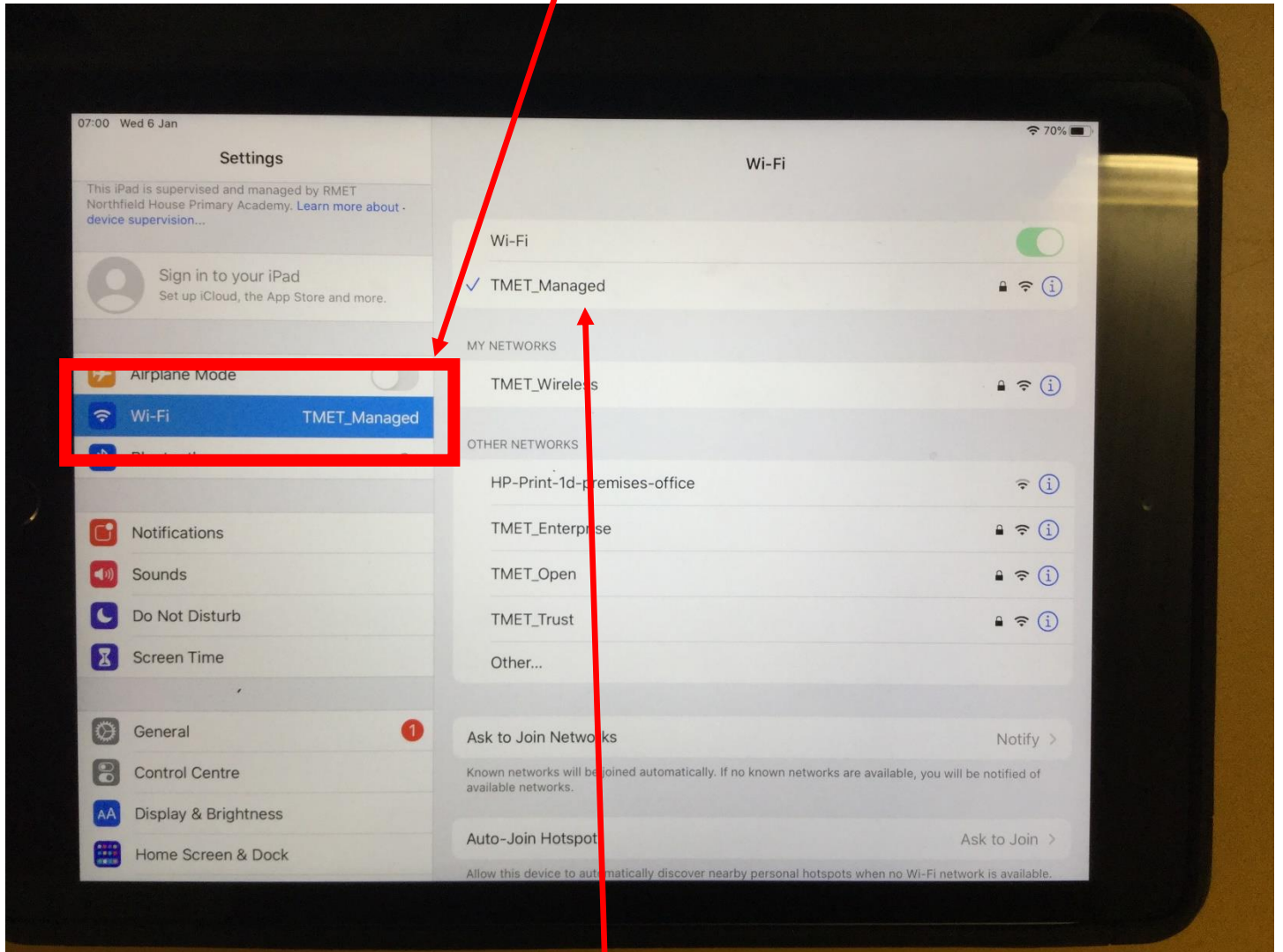

4. Tap on the name of your WiFi which should appear here. Tap on this to enter your WiFi passcode. You should now be connected to WiFi on your school ipad.